



125 MM ESCALATOR CASTER

KEEPING THE WORLD ROLLING FOR OVER 35 YEARS

P&H INTRODUCES THE HI-TECH 125MM ESCALATOR CASTER

THIS CASTER HAS A STATE OF THE ART DESIGN AT A COMPETITIVE PRICE

When pushing the trolley onto the escalator, the side polyurethane wheel will drop into the groove of the belt. This drop movement will immediately and automatically lock the caster, and the trolley will ride the escalator.

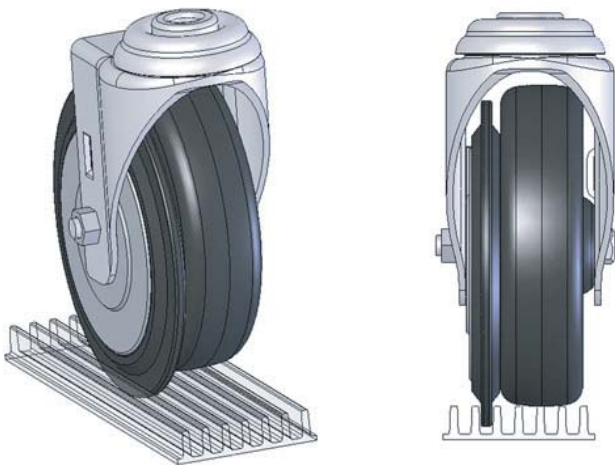

* Shown as open hole - other mounting fittings are available to meet your special requirements

FEATURES

- ▶ **HI-TECH POLYURETHANE AND NYLON SINGLE DISC FOR MAXIMUM WEAR**
- ▶ **FULL SIZE HI-TECH TPU WHEEL FOR MAXIMUM LIFE**
- ▶ **DUAL PRECISION BEARING IN LOAD WHEEL**
- ▶ **FITS ALL ESCALATOR BELTS**



CAS957-L

CAS957-R

Part No.	Mounting Part	Type
CAS957-R	M-12 (with M12 x 40 bolt)	Right-hand swivel
CAS957-L	M-12 (with M12 x 40 bolt)	Left-hand swivel

125MM Escalator Caster

- ▶ **Yoke: Pressed steel double ballrace swivel, zinc plated with laquer coating**
- ▶ **Wheel: Injection molded polypropolene hub with grey polyurethane tread, dual precision bearngs and HDPE threadguard**
- ▶ **Disc: Nylon hub with polyurethane glide and steel ball bearings**

To Order the Poly-U® 125MM Escalator Caster:
 Toll Free 1-800-354-8622
 Phone 817-468-3850 • Fax 817-468-2850
 1208 N. Commercial Blvd • Arlington, TX 76001
www.phcasters.com
info@phcasters.com